

602-620 KING STREET WEST REVISIONS

RioCan-Allied Hariri Pontarini Architects

Comparison to Previous Submissions



View Looking North West Along King and Portland



King Street Elevation



King Street Elevation



Office Entrance / Laneway View Looking North Towards Buca



Laneway View Looking South Towards King at Buca



Laneway View Looking South Behind Adelaide Place



Office Entrance / Laneway View Looking North at Waterloo Terrace



Adelaide Street Elevation



Adelaide Street Elevation



Ground Floor Landscape Plan

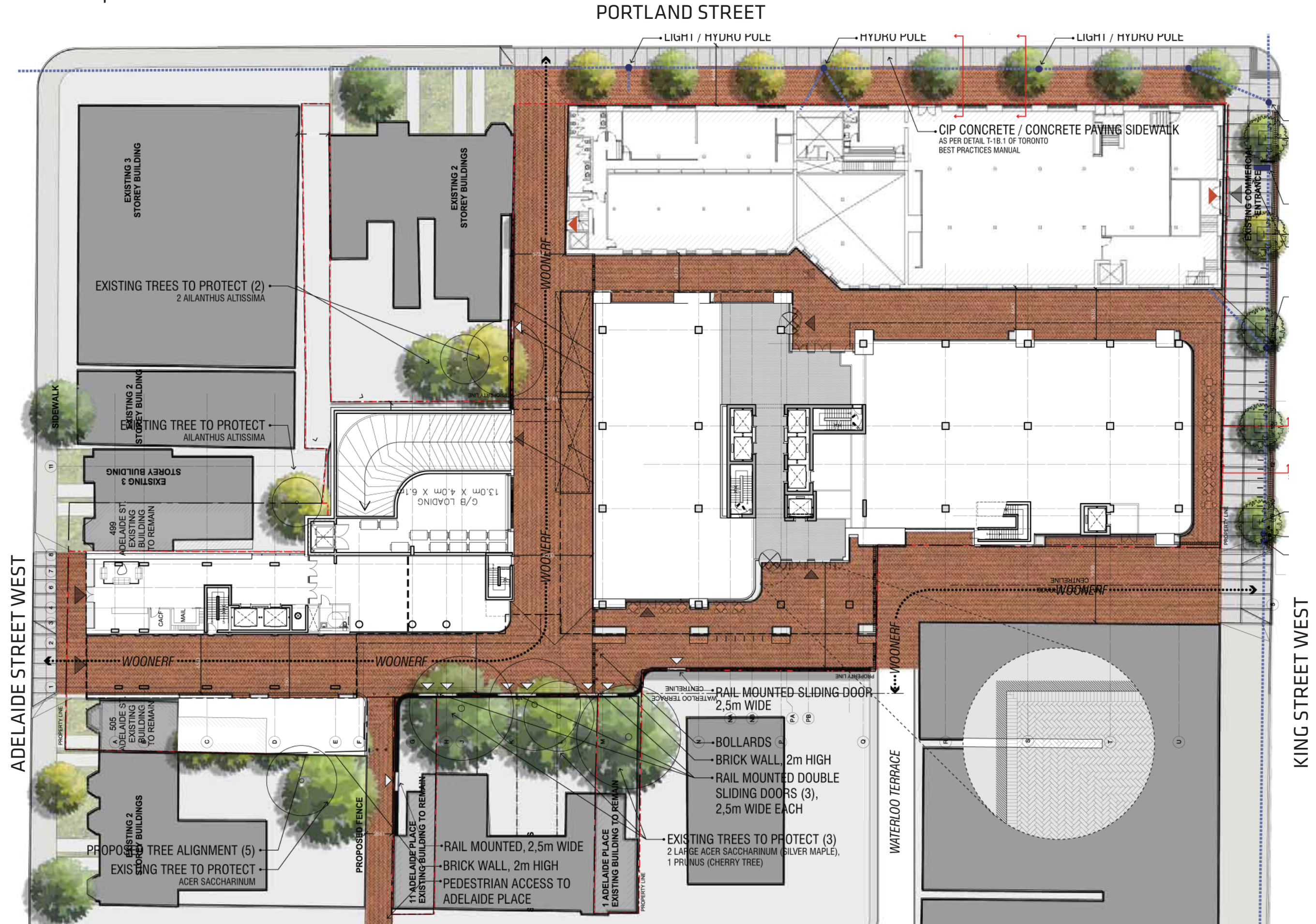

Landscape Precedent Images - Paving



CLAY PAVERS (ENDICOTT) - CHERRY STREET, DISTILLERY DISTRICT, TORONTO

IMAGE: CC+A



CONCRETE PAVERS (UNILOCK BELPASSO) - FULTON & CASS DOWN CITY, PROVIDENCE, RHODE ISLAND

IMAGE: UNILOCK



MOCK BRICK CONCRETE UNIT PAVING (UNILOCK TOWNHALL) - CHERRY STREET, DISTILLERY DISTRICT, TORONTO

IMAGE: CC+A



CONCRETE TILES - UTRECHT, NETHERLANDS

IMAGE: <http://www.landazine.com/index.php/2011/04/inkpot-utrecht-by-okra-landscape-architecture/05-okra-landscapearchitecture-utrecht-inkpot/>

Landscape Precedent Images - Walls



2m BRICK WALL - PHILADELPHIA

IMAGE: <http://travelspirit333.files.wordpress.com/2013/04/p1016231.jpg>



TYPICAL RAIL MOUNTED SLIDING DOOR - ALLEY, MONTRÉAL



VINES ON C.I.P. CONCRETE WALL - CHATEAU NOIR, MONTRÉAL

IMAGE: CC+A

Interior View Looking North Towards Adelaide



View Looking South West Along Adelaide and Portland

